

DRAWING INDEX

F-01 LEVEL 1 SPRINKLER & DETECTION ARRANGEMENT, SCOPE OF WORKS & LEGEND OF SYMBOLS
 F-02 LEVEL 2 SPRINKLER & DETECTION ARRANGEMENT

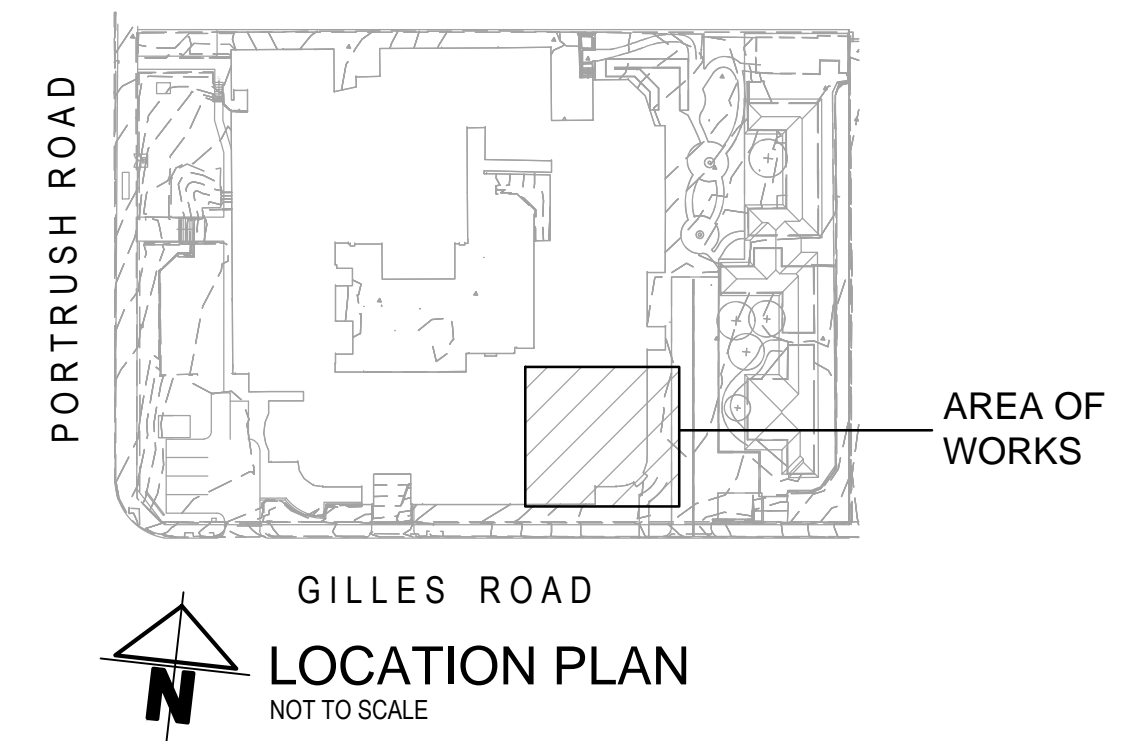

- ### FIRE PROTECTION SERVICES SCOPE OF WORKS
- CONTRACTOR TO INSPECT THE WORKS PRIOR TO SUBMISSION OF TENDERS AND REPORT ANY DISCREPANCIES TO APPLICABLE STANDARDS AND CODES TO THE FIRE PROTECTION SERVICES ENGINEER. CONFIRMATION OF INSPECTION, INCLUDING DATE AND TIME TO BE PROVIDED WITHIN TENDER SUBMISSION.
 - INSTALL ALL CABLING AND DETECTION DEVICES IN ACCORDANCE WITH THE REQUIREMENTS OF AS 1670 - AUTOMATIC FIRE DETECTION AND ALARM SYSTEMS. ALLOW TO RE-SUPPORT ALL EXISTING CABLING FOR THE DETECTION AND EWIS SYSTEM WITHIN THE WORK AREA.
 - ALLOW TO COORDINATE THE CABLING AND DETECTION DEVICES WITH ALL OTHER SERVICES AND EQUIPMENT.
 - ENSURE FIRE DETECTION SYSTEM IS OPERATIVE AT THE END OF EACH WORKING DAY OR WHEN ATTENDANCE IS NOT GUARANTEED.
 - UPDATE THE EXISTING BLOCK PLANS INDICATING ALL DETECTION DEVICE LOCATIONS FOR INCLUSION INTO THE FIRE INDICATOR PANEL. SUPPLY HARD COPIES TO THE FIRE PROTECTION SERVICES CONSULTING ENGINEER FOR APPROVAL PRIOR TO COMMENCEMENT OF WORKS ON SITE.
 - ALLOW TO REMOVE AND RE-INSTALL ALL DETECTORS AND ANY ASSOCIATED DEVICES TO ENABLE DEMOLITION OF EXISTING CEILINGS AND WALLS.
 - PROVIDE WARRANTY ON MATERIALS AND WORKMANSHIP FOR A PERIOD OF 52 WEEKS FROM THE COMPLETION DATE. ENSURE MAINTENANCE IS CARRIED OUT IN ACCORDANCE WITH AS 1851.
 - ISOLATE AND DE-ISOLATE SYSTEM AS DIRECTED BY THE BUILDER TO ENABLE BUILDING WORKS TO BE UNDERTAKEN.
 - INSTALL ALL PORTABLE FIRE EXTINGUISHERS AND BLANKETS IN ACCORDANCE WITH AS 2444. FINAL LOCATIONS TO BE REVIEWED AND CONFIRMED ON SITE.
 - COORDINATE THE INSTALLATION OF NEW PIPEWORK AND NEW SPRINKLER LOCATIONS WITH ALL OTHER SERVICES AND EQUIPMENT, STRUCTURE, CEILING AND LIGHTING ZONES.
 - UTILISE EXISTING CEILING SPRINKLERS AND PIPEWORK FOR CONNECTION OF DROPPERS AND ARM PIECES TO NEW CEILING SPRINKLER LOCATIONS. PROVIDE NEW SPRINKLERS AND ASSOCIATED PIPEWORK WHERE REQUIRED.
 - ALLOW TO REPLACE DAMAGED OR MISSING AUTOMATIC SPRINKLER ESCUTCHEON PLATES WHERE NECESSARY WITHIN THE 'AREA OF WORKS', INCLUDING ALL ASSOCIATED WORKS.
 - COORDINATE WITH THE MECHANICAL SERVICES CONTRACTOR FOR THE RELOCATION OF EXISTING AND THE INSTALLATION OF NEW AIR CONDITIONING UNITS AND ASSOCIATED DUCTWORK WITHIN THE CEILING SPACE. RELOCATE EXISTING MAIN AND RANGE PIPEWORK AND CONCEALED SPACE SPRINKLERS AS NECESSARY TO COMPLY WITH AUSTRALIAN STANDARD 2118. REFER TO THE MECHANICAL SERVICES CONTRACTORS CONSTRUCTION SHOP DRAWINGS FOR EXTENT OF DUCTWORK.
 - ENSURE COMPLIANCE WITH AUSTRALIAN STANDARD 2118 CODE FOR AUTOMATIC FIRE SPRINKLER SYSTEMS.
 - PROVIDE SUPPORTS FOR ALL PIPEWORK IN ACCORDANCE WITH AUSTRALIAN STANDARD 2118.9. ENSURE ALL EXISTING SUPPORTS ARE IN ACCORDANCE WITH AUSTRALIAN STANDARD 2118.9. MAKE ALLOWANCE TO RECTIFY WHERE NECESSARY.
 - ALL PIPEWORK TO BE BLACK MILD STEEL, MEDIUM DUTY TO AUSTRALIAN STANDARD 1074.
 - CONDUCT PRESSURE TESTING OF PIPEWORK AND FITTINGS IN ACCORDANCE WITH AUSTRALIAN STANDARD 2118. UNDERTAKE PRESSURE TESTING PRIOR TO COMMENCING WORK AND ON COMPLETION.
 - PAINT ALL PIPEWORK WITH ONE COAT OF RED OXIDE PRIMER.
 - ALLOW FOR THE INSTALLATION OF 3 OFF ADDITIONAL CEILING MOUNTED AND 5 OFF CONCEALED SPACE AUTOMATIC FIRE SPRINKLERS TO THOSE NOMINATED ON THIS DRAWING.
 - ALLOW FOR ALL SYSTEM 'DRAIN DOWNS'.
 - NOTIFY BUILDING OWNER OR BUILDING OWNERS REPRESENTATIVE OF TIMES WHEN SPRINKLERS WILL BE INOPERATIVE PRIOR TO DRAIN DOWN OF SYSTEM.
 - CHECK AND SEAL ALL PENETRATIONS THROUGH EXISTING FIRE AND ACOUSTIC WALLS AND RE-SEAL ALL PENETRATIONS WHICH COMPROMISE THE INTEGRITY OF THE FIRE AND ACOUSTIC BARRIERS.
 - PROVIDE 3 OFF COPIES OF 'AS INSTALLED DRAWINGS' AND INSERTS TO THE EXISTING OPERATING AND MAINTENANCE MANUAL. UPDATE EXISTING 'AS INSTALLED' DRAWINGS TO REFLECT MODIFICATIONS. SUPPLY HARD COPIES OF CONSTRUCTION 'FOR APPROVAL' SHOP DRAWINGS TO THE FIRE PROTECTION SERVICES CONSULTING ENGINEER FOR APPROVAL PRIOR TO PROCUREMENT OF MATERIALS AND TO COMMENCEMENT OF WORKS ON SITE.
 - SUPPLY PDF COPY OF CONSTRUCTION 'FOR REVIEW' SHOP DRAWINGS TO THE FIRE PROTECTION SERVICES CONSULTING ENGINEER FOR REVIEW PRIOR TO PROCUREMENT OF MATERIALS AND TO COMMENCEMENT OF WORKS ON SITE.
 - TAKE DESIGN RESPONSIBILITY IN ORDER TO SIGN AN UNCONDITIONAL FORM 2 ON COMPLETION.
 - PROVIDE INSTALLERS STATEMENT OF COMPLIANCE FOR THE FIRE DETECTION AND FIRE SPRINKLER SYSTEM AS REQUIRED BY AUSTRALIAN STANDARD 1670 AND AUSTRALIAN STANDARD 2118.
 - MAKE NECESSARY PROVISION TO UPDATE THE EXISTING MAINTENANCE AND TESTING MANUAL TO THE REQUIREMENTS OF SA76 MINISTER SPECIFICATION.
 - SUPPLY UNIT RATES OUTLINING COST FOR THE SUPPLY AND INSTALLATION FOR EACH ITEM OF EQUIPMENT AT DESIGN, CONSTRUCTION AND COMPLETION STAGES.

LEGEND OF SYMBOLS

- SPRINKLER HEAD EXPOSED UPRIGHT
 - SPRINKLER HEAD SEMI-RECESSED CEILING MOUNTED
 - THERMAL DETECTOR EXPOSED OR CEILING MOUNTED
 - SMOKE DETECTOR CEILING MOUNTED
P - DENOTES PHOTO-OPTICAL TYPE
 - WARDEN INTERCOM PHONE
 - MANUAL CALL POINT
 - FIRE HOSE REEL
 - SINGLE HEADED FIRE HYDRANT
 - DOUBLE HEADED FIRE HYDRANT
 - CARBON DIOXIDE EXTINGUISHER - 5KG 5B:E
 - WATER EXTINGUISHER - 9L 3A
 - DRY CHEMICAL POWDER EXTINGUISHER - 4.5KG 4A:80B:E
- PREFIXES:**
- E EXISTING ITEM TO REMAIN
 - R EXISTING ITEM TO BE RELOCATED
 - N NEW ITEM
 - D EXISTING ITEM TO BE DELETED

P:\56928 Drawings\FIRE\56928 F-01.dwg 11/10/2021 3:46:44 PM andrea.szabo

Issue	Amendments	Date	Init.
A	ISSUE FOR PREPARATION OF CONSTRUCTION DRAWINGS	11.10.21	ADS

North

Architect

marchesepartners

Marchese Partners International Pty Ltd.
 Level 1, 53 Walker Street, North Sydney, NSW 2060 Australia
 P +61 2 9622 4235 F +61 2 9622 5766 E info@marchesepartners.com
 www.marchesepartners.com

Sydney Brisbane Canberra Melbourne Adelaide
 Perth London Auckland Christchurch London Madrid
 ABN 20 008 552 151



BESTEC
 ABN 43 909 272 047
 T: (08) 8232 4442
 F: (08) 8232 4244
 E: consulting@bestec.com.au
 A: 144 Gawler Place
 Adelaide, 5000
 South Australia
 G.P.O. Box 816,
 Adelaide 5001
 W: bestec.com.au

Project	Drawn	Checked	Date
LIFE CARE - GLENROSE COURT WATTLE WING UPGRADE	NW		JULY 2021
Title	Designed	Checked	Scale
FIRE PROTECTION SERVICES	NW		1:100 @A1
LEVEL 1 SPRINKLER & DETECTION ARRANGEMENT, SCOPE OF WORKS & LEGEND OF SYMBOLS	56928	F-01	A

CONSTRUCTION ISSUE

BESTEC
 DOCUMENT ISSUE
 Date
 11-Oct-21
 BESTEC
 ABN 43 909 272 047
 BUILDING ENGINEERING
 SERVICES TECHNOLOGIES
 CONSULTING ENGINEERS

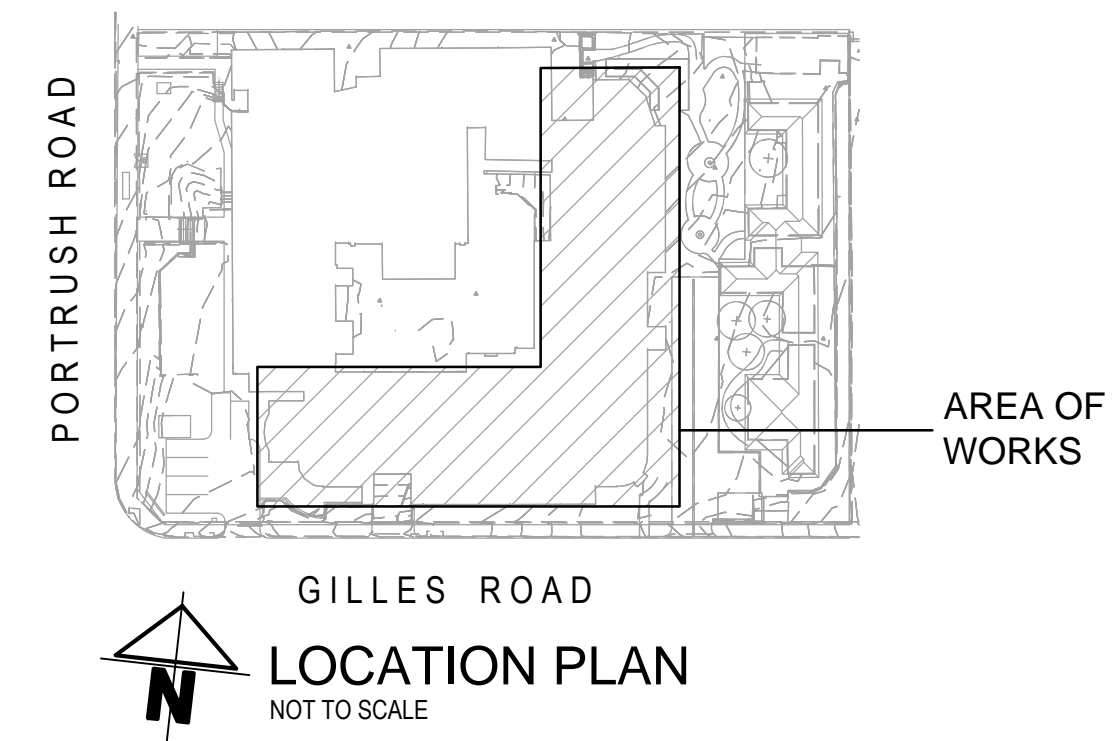

BESTEC	
DOCUMENT ISSUE	
Date	11-Oct-21
BESTEC ABN 43 909 272 047 BUILDING ENGINEERING SERVICES TECHNOLOGIES CONSULTING ENGINEERS	

CONSTRUCTION ISSUE

Issue	Amendments	Date	Init.
A	ISSUE FOR PREPARATION OF CONSTRUCTION DRAWINGS	11.10.21	ADS

North

Architect

marchesepartners
Marchese Partners International Pty Ltd
Level 1, 53 Walker Street, North Sydney, NSW 2060 Australia
P +61 2 9622 4375 F +61 2 9622 5766 E info@marchesepartners.com
www.marchesepartners.com
Sydney Brisbane Canberra Melbourne Adelaide
Preston London Auckland Christchurch London Madrid
ABN 20 098 552 151



BESTEC
ABN 43 909 272 047
T. (08) 8232 4442
F. (08) 8232 4244
E. consulting@bestec.com.au
A. 144 Gawler Place
Adelaide, 5000
South Australia
G.P.O. Box 816,
Adelaide 5001
W. bestec.com.au

Project	LIFE CARE - GLENROSE COURT WATTLE WING UPGRADE	Drawn	NW	Checked	<i>[Signature]</i>	Date	JULY 2021
Title	FIRE PROTECTION SERVICES	Designed	NW	Checked	<i>[Signature]</i>	Scale	1:100 @A1
LEVEL 2 SPRINKLER & DETECTION ARRANGEMENT		Project Number	56928	Drawing Number	F-02	Issue	A

P:\56928 Drawings\FIRE\56928 F-02.dwg 11/10/2021 1:33:01 PM andre szabo

TRANSFER OF DOCUMENTS



Project Name: Life Care - Glenrose Court Wattle Wing Upgrade

Recipient: Life Care - Mr G Maughan

Sheet No: 1 of 1

Project No: 56928

Discipline		Date of Issue					
FIRE PROTECTION SERVICES		D	18	30	08	13	11
		M	06	06	07	07	10
		Y	21	21	21	21	21
Drawing No	Drawing Title	Revision					
F-01	LEVEL 1 SPRINKLER & DETECTION ARRANGEMENT, SCOPE OF WORKS & LEGEND OF SYMBOLS	01	02			A	
F-02	LEVEL 2 SPRINKLER & DETECTION ARRANGEMENT	01	02	03		A	
Recipients		Transfer Format					
		CD - Compact Disc, E - Email, AC - Aconex, DB - Dropbox, TB - Team Binder					
Life Care - Mr G Maughan		E	E	E	E	E	
Life Care - Mr P Bermoser						E	
Marchese Partners - Mr J Braun		E	E	E	E		
Marchese Partners - Mr S Colegate		E	E	E	E	E	
Marchese Partners - Ms L G Almanza		E	E	E	E	E	
Pt Design - Mr S Case		E	E	E	E	E	
Revision Status:	CONSTRUCTION ISSUE	X - For Information	T - Tender	A1 - Addendum 1			
		P - Preliminary	R - Revision	C - Construction			
		Co - Coordination	A - Approval	S - Shop Drawings			
Reason for Issue:		P	P	P	T	C	